

REVISIONS				
ZONE	LTR	DESCRIPTION	DATE	APPROVAL

NOTE UNLESS OTHERWISE SPECIFIED:

- PART TO BE FABRICATED FROM CHEMICALLY BRIGHTENED ALUMINUM, PRINTED WITH INK TO FORM INFRA-RED REFLECTIVE AND ABSORPTIVE PATTERN  
PATTERN TO BE FORMED TO INTERRUPT LIGHT PATH INDICATED BY ARROW "C".
- INDICATED SURFACE TO BE UNIFORMLY COATED WITH PRESSURE SENSITIVE ADHESIVE, NECAL 9501. ADHESIVE TO BE .002 +/- .001 THICK. PART TO BE SUPPLIED WITH RELEASE LINER ON ADHESIVE SIDE.
- TOLERANCES: .XXX = +/- .005
- REGISTRATION TOLERANCE OF ARTWORK TO PART IS +/- .010.
- ARTWORK IS ALSO AVAILABLE AS AN ENCAPSULATED POSTSCRIPT FILE ON REQUEST.
- SURFACE TO HAVE INDICATED STRAIGHTNESS ALONG ANY RADIAL SECTION SUCH AS SECTION B-B.
- RADIUS INDICATES NOMINAL LIGHT PATH CENTERLINE AS PART ROTATES.
- THE PRINTED PATTERN CONSISTS OF 120 BLACK STRIPES AND 120 EQUAL SPACES BETWEEN STRIPES.
- CLEAR EPOXY TOP COAT TO BE APPLIED OVER PRINTED PATTERN.

2

6

7

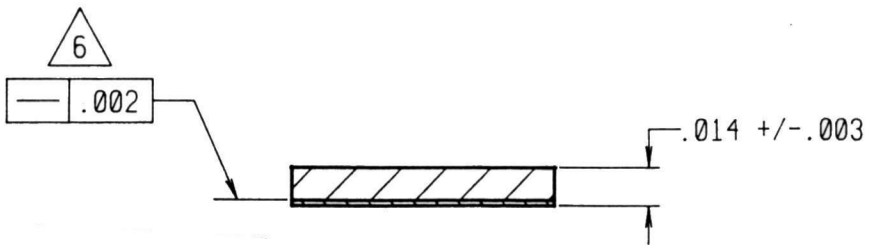
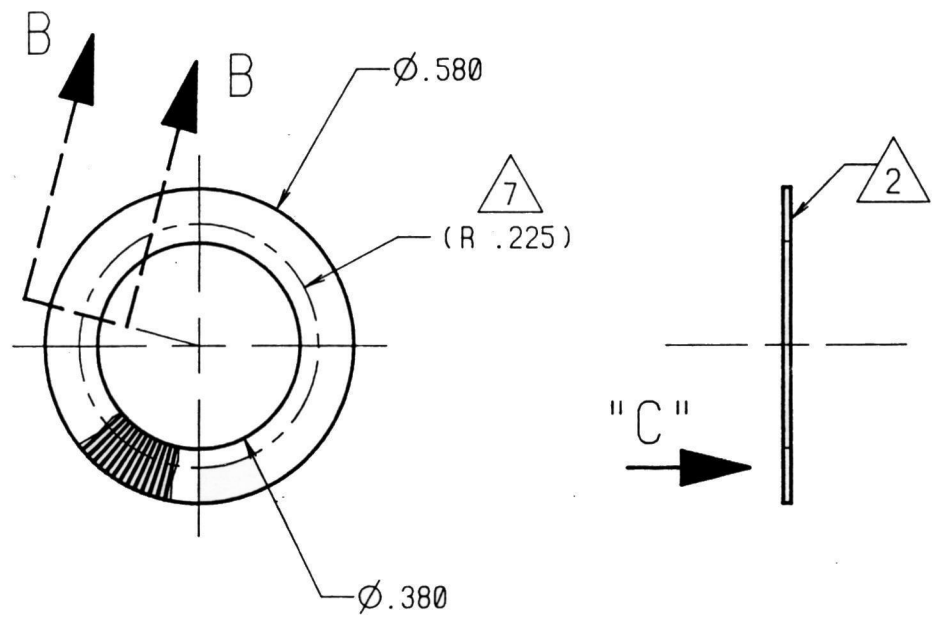

SECTION B-B  
SCALE: 20/1

TOL: SEE NOTE		ENCODER RING, HIGH RESOLUTION	
APPROVAL DATE	APPROVAL DATE	SCALE= 4X	B
DR	MFG		
CHK	QA		
ENGR	MKTG	DO NOT SCALE DRWG	SHEET 1 OF 1