

RECOMMENDED PCB LAYOUT: COMPONENT SIDE

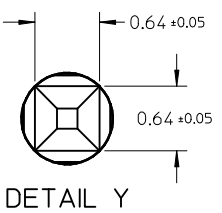
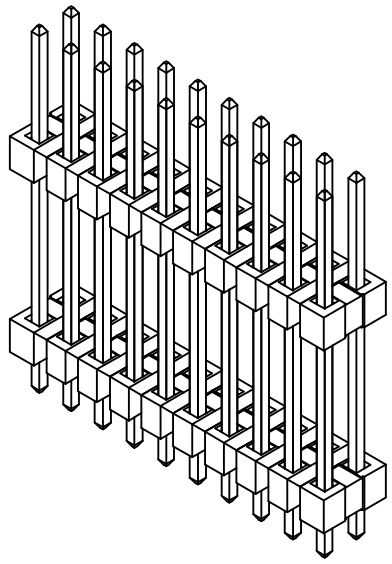
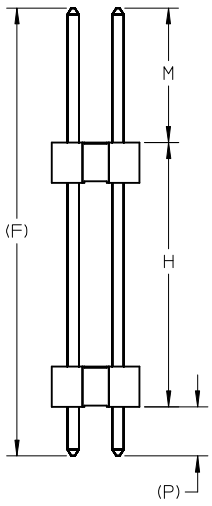
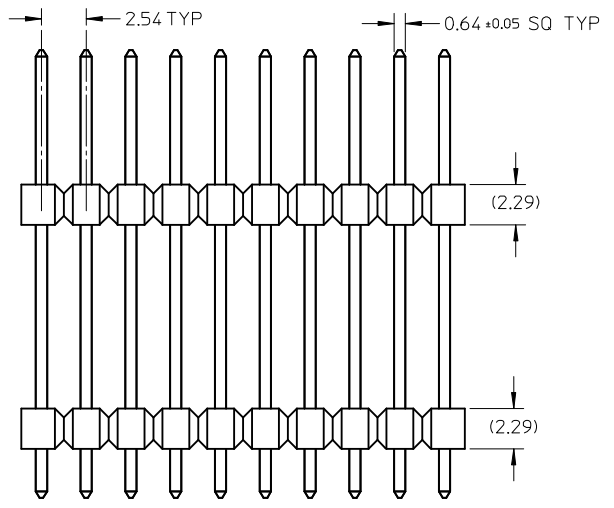

- NOTES:
- MATERIAL:
 - HOUSING: LCP, GLASS FILLED, UL94V-0
 - COLOR: BLACK
 - PIN: COPPER ALLOY, SQ, 0.64MM
 - PLATING FINISH:
 - GOLD FLASH OVERALL OVER
1.25µm MIN. NICKEL OVERALL
 - 0.05µm MIN. GOLD IN CONTACT AREA AND
2.50µm MIN. TIN IN SOLDER AREA OVER
1.25µm MIN. NICKEL OVERALL
 - 0.38µm MIN. GOLD IN CONTACT AREA AND
2.00µm MIN. TIN IN SOLDER AREA OVER
1.25µm MIN. NICKEL OVERALL
 - 0.75µm MIN. GOLD IN CONTACT AREA AND
2.00µm MIN. TIN IN SOLDER AREA OVER
1.25µm MIN. NICKEL OVERALL
 - 2.50µm MIN. TIN OVERALL
1.25µm MIN. NICKEL OVERALL
 - FOR PACKING OPTION PLEASE REFER TO THE TABLE.
 - THE ABOVE 20CKTS SHOWN IS FOR ILLUSTRATION ONLY.
 - IRREGULAR CIRCUIT CUTOFF WITHIN BREAKAWAY SECTION IS PERMISSIBLE. CUTTING OR CHIPPING OF THE MAIN BODY IS NOT ACCEPTABLE
 - WAFER TO BE FLAT WITHIN 0.003mm/mm
 - PARTS ARE NOT STACKABLE ON 2.54 CENTERS
 - RECOMMENDED PCB THICKNESS 1.60±0.10mm
 - PRODUCT SPEC: PS-87920-019
 - PACKAGING SPECIFICATION:
 - TRAY: PK-89990-489
 - BULK: PK-89990-491

ADD 87797-1200 EC NO: S2009-0567 DRWN:SKANG 2009/02/23 CHKD:ATSEE 2009/02/23 APPR:MLONG 2009/02/23	QUALITY SYMBOLS	GENERAL TOLERANCES (UNLESS SPECIFIED)		DIMENSION STYLE MM ONLY		SCALE NTS	DESIGN UNITS METRIC	THIRD ANGLE PROJECTION	
	▽=0 Ⓢ=0	mm	INCH	DRAWN BY	DATE	TITLE			
		4 PLACES ± --- ± ---	SKLIM01	2006/03/01	CUSTOM HEADER 2.54MM PITCH DUAL ROW HEADER, THRU HOLE, VERT				
		3 PLACES ± --- ± ---	CHECKED BY	DATE					
2 PLACES ± 0.2 ± ---	PATEY	2006/03/03	MOLEX INCORPORATED						
1 PLACE ± --- ± ---	APPROVED BY	DATE							
ANGULAR ± 3 °	PATEY	2006/03/03	MATERIAL NO.	DOCUMENT NO.	SHEET NO.				
DRAFT WHERE APPLICABLE MUST REMAIN WITHIN DIMENSIONS	SEE TABLE	SD-87797-171		1 OF 2					
A15	SIZE	THIS DRAWING CONTAINS INFORMATION THAT IS PROPRIETARY TO MOLEX INCORPORATED AND SHOULD NOT BE USED WITHOUT WRITTEN PERMISSION							

CKT SIZE	DIMENSION		PART NO FOR TRAY PACKAGING	PART NO FOR BULK PACKAGING	CKT SIZE	PEG OPTION	VOID POSITION	PLATING TYPE	DIMENSION			
	A	B							F	MATING END	STACKER HEIGHT	SOLDER TAIL
										M	H	P
04	5.08	2.54										
06	7.62	5.08	87797-0600	-	6	NO	-	4	26.80	4.00	20.00	2.80
08	10.16	7.62	87797-0601	-	6	NO	-	5	11.00	3.00	5.00	3.00
10	12.70	10.16	87797-0602	-	6	NO	-	4	33.60	5.00	25.60	3.00
12	15.24	12.70	87797-0603	-	6	NO	-	5	33.60	5.00	25.60	3.00
14	17.78	15.24	87797-0604	-	6	NO	-	4	35.70	7.90	25.00	2.80
16	20.32	17.78	87797-0800	-	8	NO	-	5	18.54	3.05	12.70	2.79
18	22.86	20.32	87797-1001	-	10	NO	-	5	32.14	10.80	19.05	2.29
20	25.40	22.86	87797-1002	-	10	NO	-	2	18.54	8.13	7.62	2.79
22	27.94	25.40	87797-1200	-	12	NO	-	4	19.30	9.04	8.00	2.26
24	30.48	27.94	87797-1400	-	14	NO	-	4	20.96	9.91	8.00	3.05
26	33.02	30.48	87797-1401	-	14	NO	-	5	13.00	4.00	5.00	4.00
28	35.56	33.02	87797-0020	-	20	NO	-	5	21.30	3.10	15.10	3.10
30	38.10	35.56	87797-0200	-	20	NO	-	3	36.32	5.18	25.98	5.16
32	40.64	38.10	87797-0201	-	20	NO	-	5	20.68	2.79	15.10	2.79
34	43.18	40.64	87797-2000	-	20	NO	-	4	31.00	8.50	14.00	8.50
36	45.72	43.18	87797-2002	-	20	NO	-	4	33.60	5.00	25.60	3.00
38	48.26	45.72	87797-2003	-	20	NO	-	5	33.60	5.00	25.60	3.00
40	50.80	48.26	87797-2004	-	20	NO	-	4	33.40	5.00	25.60	2.80
42	53.34	50.80	87797-2600	-	26	NO	-	3	19.30	7.25	9.00	3.05
44	55.88	53.34	87797-0400	-	40	NO	-	3	25.40	9.91	12.70	2.79
46	58.42	55.88	-	87797-0500	50	NO	-	3	18.55	6.48	9.40	2.67
48	60.96	58.42	-	87797-6400	64	NO	-	3	23.62	5.59	15.24	2.79
50	63.50	60.96	87797-1800	-	18	NO	11 & 12	1	28.00	12.21	9.35	6.44
52	66.04	63.50										
54	68.58	66.04										
56	71.12	68.58										
58	73.66	71.12										
60	76.20	73.66										
62	78.74	76.20										
64	81.28	78.74										
66	83.82	81.28										
68	86.36	83.82										
70	88.90	86.36										
72	91.44	88.90										
74	93.98	91.44										
76	96.52	93.98										
78	99.06	96.52										
80	101.60	99.06										

ADD 87797-1200 EC NO: S2009-0567 DRWN:SKANG 2009/02/23 CHKD:ATSEE 2009/02/23 APPR:MLONG 2009/02/23	QUALITY SYMBOLS =0 =0	GENERAL TOLERANCES (UNLESS SPECIFIED) <table border="1"> <tr> <th></th> <th>mm</th> <th>INCH</th> </tr> <tr> <td>4 PLACES</td> <td>± ---</td> <td>± ---</td> </tr> <tr> <td>3 PLACES</td> <td>± ---</td> <td>± ---</td> </tr> <tr> <td>2 PLACES</td> <td>± 0.2</td> <td>± ---</td> </tr> <tr> <td>1 PLACE</td> <td>± ---</td> <td>± ---</td> </tr> </table>		mm	INCH	4 PLACES	± ---	± ---	3 PLACES	± ---	± ---	2 PLACES	± 0.2	± ---	1 PLACE	± ---	± ---	DIMENSION STYLE MM ONLY DRAWN BY: SKLIM01 DATE: 2006/03/01 CHECKED BY: PATEY DATE: 2006/03/03 APPROVED BY: PATEY DATE: 2006/03/03	SCALE: NTS DESIGN UNITS: METRIC THIRD ANGLE PROJECTION	TITLE: CUSTOM HEADER 2.54MM PITCH DUAL ROW HEADER, THRU HOLE, VERT MOLEX INCORPORATED
		mm	INCH																	
	4 PLACES	± ---	± ---																	
	3 PLACES	± ---	± ---																	
2 PLACES	± 0.2	± ---																		
1 PLACE	± ---	± ---																		
DRAFT WHERE APPLICABLE MUST REMAIN WITHIN DIMENSIONS	MATERIAL NO.: SEE TABLE DOCUMENT NO.: SD-87797-171 SHEET NO.: 2 OF 2	THIS DRAWING CONTAINS INFORMATION THAT IS PROPRIETARY TO MOLEX INCORPORATED AND SHOULD NOT BE USED WITHOUT WRITTEN PERMISSION																		